



PROJECT TITLE: FERTIL-SYNERGY FOR PROCESS CONDENSATE, AMMONIA WATER & UREA SOLUTION BETWEEN F-1 & F-2

COMMENT RESOLUTION SHEET (CRS)

Document Title:
NAME PLATE DRAWING



Document Reference No & Rev No. : F2-96-SS-GEA-0001-031_Rev.C03

AGREEMENT NO.: 102402-2024

S.No.	COMMENT SECTION / CLAUSE / DRAWING REFERENCE	COMPANY COMMENTS	CONTRACTOR RESOLUTION	COMPANY CONFIRMATION	REMARKS
1	F2-96-SS-GEA-0001-031 Rev.C01	update logo	Noted and Updated	Closed	
2	F2-96-SS-GEA-0001-031 Rev.C01	ADNOC FERTIL	Noted and Updated	Closed	
3	F2-96-SS-GEA-0001-031 Rev.C01	equipment details to be mentioned eg: Conductivity Analyzer	Noted and Updated	Closed	
4	F2-96-SS-GEA-0001-031 Rev.C01	no stanchion or support ? vendor to clarify the mounting	Analyzer mounted backplate shall be mounted on the unistrut fixed on the cabinet wall.	Closed	
5	F2-96-SS-GEA-0001-031 Rev.C01	PRV228100	Noted and Updated	Closed	
6	F2-96-SS-GEA-0001-031 Rev.C01	Vendor to clarify the components for TOC and Analyzer.if this sample flow cell is for Conductivity, tag shall be AE228100A	Noted and Updated	Closed	
7	F2-96-SS-GEA-0001-031 Rev.C01	Only indication or signal transmission? Tag shall be FI228100	Only indication	Closed	
8	F2-96-SS-GEA-0001-031 Rev.C01	AT228100B TOC as per P&ID/datasheet	Noted and Updated	Closed	
9	F2-96-SS-GEA-0001-031 Rev.C01	Fertil logo to be used (typical)	Noted and Updated	Closed	
10	F2-96-SS-GEA-0001-031 Rev.C01	AT228100A Conductivity	Noted and Updated	Closed	
11	F2-96-SS-GEA-0001-031 Rev.C02	Fertil	Noted and Updated	Closed	
12	F2-96-SS-GEA-0001-031 Rev.C02	3S?	Noted and Updated	Closed	
13	F2-96-SS-GEA-0001-031 Rev.C02	range to be checked	Noted and Updated	Closed	
14	F2-96-SS-GEA-0001-031 Rev.C02	Hazardous area & Gas group where these analyzers will be installed to be checked and update	Noted and Updated	Closed	
15	F2-96-SS-GEA-0001-031 Rev.C02	AE228100A	Noted and Updated	Closed	
16	F2-96-SS-GEA-0001-031 Rev.C02	PSV228200A	Noted and Updated	Closed	
17	F2-96-SS-GEA-0001-031 Rev.C02	PSV228201A	Noted and Updated	Closed	
18	F2-96-SS-GEA-0001-031 Rev.C02	PSV228200B	Noted and Updated	Closed	
19	F2-96-SS-GEA-0001-031 Rev.C02	PSV228201B	Noted and Updated	Closed	
20	F2-96-SS-GEA-0001-031 Rev.C02	FI228200	Noted and Updated	Closed	
21	F2-96-SS-GEA-0001-031 Rev.C03	TBD to be updated	model number is Updated. Serial number we will provide once we receive the analyzer		
22	F2-96-SS-GEA-0001-031 Rev.C03	Flow cell not part of sensor? no need separate tag for this	Noted and Updated		
23	F2-96-SS-GEA-0001-031 Rev.C03	AT228100A	Noted and Updated		
24	F2-96-SS-GEA-0001-031 Rev.C03	AE228100A is the sensor tag	Noted and Updated		



AGREEMENT NO. 102402-2024

PROJECT TITLE: FERTIL-SYNERGY FOR PROCESS CONDENSATE,
AMMONIA WATER & UREA SOLUTION BETWEEN F-1 & F-2



F2-96-SS-GEA-0001-031

NAME PLATE DRAWING FOR CONDUCTIVITY AND
TOC ANALYSER

REV.C04

FERTIL - SYNERGY FOR PROCESS CONDENSATE,
AMMONIA WATER & UREA SOLUTION
BETWEEN F-1 & F-2

AGREEMENT NO. 102402-2024

NAME PLATE DRAWING FOR CONDUCTIVITY AND
TOC ANALYSER

DOC NO: F2-96-SS-GEA-0001-031

Fertiglobe

An ADNOC Company

TECHNICAL AND INTEGRITY DIVISION
ENGINEERING & ASSET INTEGRITY DEPT
ENGINEERING

NO COMMENT

C04	27/11/2024	Issued for Review (IFR)	MP	VV	SP
REV.	DATE	REVISION DESCRIPTION	PRPD	CHKD	APPD



AGREEMENT NO. 102402-2024

**PROJECT TITLE: FERTIL-SYNERGY FOR PROCESS CONDENSATE,
AMMONIA WATER & UREA SOLUTION BETWEEN F-1 & F-2**



F2-96-SS-GEA-0001-031

**NAME PLATE DRAWING FOR CONDUCTIVITY AND
TOC ANALYSER**

REV.C04

1. NAME PLATE DRAWING

NAMEPLATE DRAWING- TOC & CONDUCTIVITY ANALYZER

NOTE: ALL DIMENSIONS ARE IN MM

	
PROJECT REFERENCE	APS-252 SYNERGY FOR PROCESS CONDENSATE.
CLIENT	FERTIL
TAG NO	AT228100A
ANALYZER MAKE	EMERSON
ANALYZER TYPE	CONDUCTIVITY
ANALYZER MODEL NO	5081C
PRESSURE RATING	18 barg (Max)
YEAR OF MANUFACTURE	2024
SERIAL NO	TBD
INSTRUMENT RANGE	0-30µS/cm
WETTED PARTS	SS316L
P.O NUMBER	PO-APS-252-013
SE REF .NO	SE24-0017-004

MATERIAL: SS316
 SIZE: 245X 190MM
 THK: 1 MM
 CHARACTER COLOUR: BLACK
 TYPE: ENGRAVED
 QTY: 4 EA
 TEXT STYLE : ARIAL
 TEXT HEIGHT : 4 mm

	
PROJECT REFERENCE	APS-252 SYNERGY FOR PROCESS CONDENSATE.
CLIENT	FERTIL
TAG NO	AT228100B
ANALYZER MAKE	3S
ANALYZER TYPE	TOC
ANALYZER MODEL NO	3S-TM
PRESSURE RATING	18 barg (Max)
YEAR OF MANUFACTURE	2024
SERIAL NO	TBD
INSTRUMENT RANGE	0-20 ppm
WETTED PARTS	SS316L
P.O NUMBER	PO-APS-252-013
SE REF .NO	SE24-0017-004

CONDUCTIVITY ANALYZER

TOC ANALYZER

REV	DATE	ISSUED FOR	DRAWN	CHKD	APPRD
C04	25-11-24	ISSUED FOR APPROVAL	VPS	WV	SP
C03	18-11-24	ISSUED FOR APPROVAL	RJK	WV	SP
C02	07-10-24	ISSUED FOR REVIEW	RJK	WV	
C01	12-09-24	ISSUED FOR REVIEW	RJK	WV	SP

SCALE: 1:1	DRAWN: RIJIN	CHKD: VIVISH	APPRD: SINOGE
------------	--------------	--------------	---------------

CONTRACTOR
 ADVANCED PETRO SERVICES

VENDOR:
 SYSTEMS EQUIPMENT

PROJECT TITLE
 APS-252SYNERGY FOR PROCESS CONDENSATE, AMMONIA WATER AND UREA SOLUTION BETWEEN F-1 & F-2

DRAWING TITLE
 TOC & CONDUCTIVITY ANALYZER NAMEPLATE & TAGPLATE DRAWING

UNIT: mm	PLANT: XX-----XXX--X
CONTR. PROJ. No. SO-SE2024-0289	CONT. DWG. No.: SE24-0289-ED-ND-001
ADNOC AGREEMENT No. 102402-2024	
ADNOC PROJ. No. XXXX	ADNOC DWG. No. F2-00-CI-GEA-0005
SHEET 01/02	REV. C04

NOTICE: THIS DRAWING AND THE INFORMATION IT CONTAINS IS THE SOLE PROPERTY OF ADNOC GAS. IT SHALL NOT BE REPRODUCED OR LENT WITHOUT THE AGREEMENT OF THE OWNER.

CAD NO.: T_11

NAMEPLATE & TAGPLATE DRAWING- CONDUCTIVITY ANALYZER
 TOC & CONDUCTIVITY ANALYZER (TAG NO:AT228100B & AT228100A)

NOTE: ALL DIMENSIONS ARE IN MM

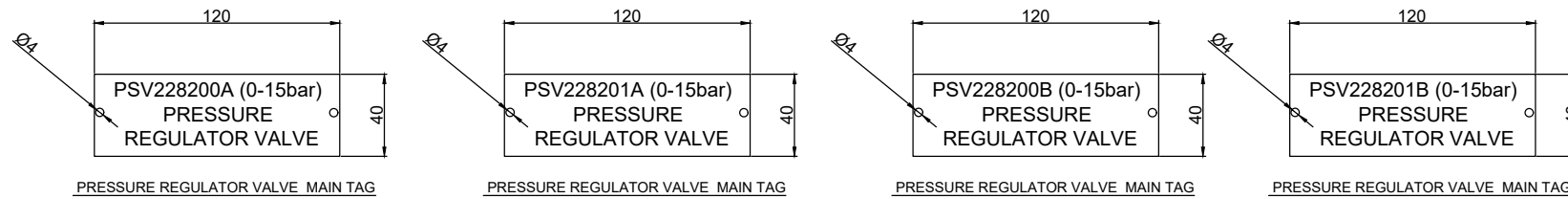

NOTES:
 DIMENSION : 120(W) x 40(H) x 1.5 (THK)
 MATERIAL : SS316L
 BACKGROUND : WHITE (RAL 9010)
 TEXT COLOUR : BLACK
 TEXT STYLE : ARIAL
 TEXT HEIGHT : 07 MM
 FIXING STYLE : SS SCREWED

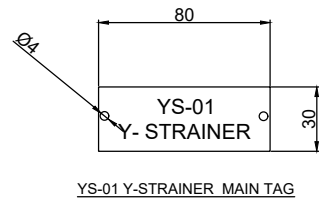

NOTES:
 DIMENSION : 80(W) x 30(H) x 1.5 (THK)
 MATERIAL : SS316L
 BACKGROUND : WHITE (RAL 9010)
 TEXT COLOUR : BLACK
 TEXT STYLE : ARIAL
 TEXT HEIGHT : 07 MM
 FIXING STYLE : SS SCREWED

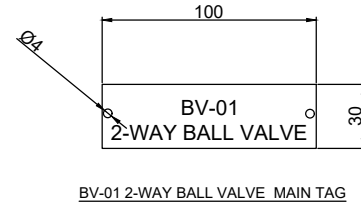

NOTES:
 DIMENSION : 100(W) x 30(H) x 1.5 (THK)
 MATERIAL : SS316L
 BACKGROUND : WHITE (RAL 9010)
 TEXT COLOUR : BLACK
 TEXT STYLE : ARIAL
 TEXT HEIGHT : 07 MM
 FIXING STYLE : SS SCREWED

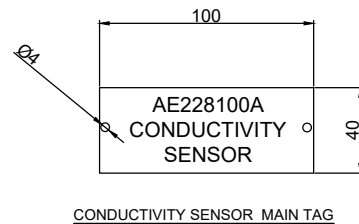
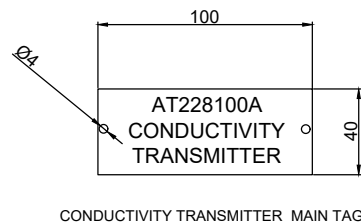

NOTES:
 DIMENSION : 100(W) x 40(H) x 1.5 (THK)
 MATERIAL : SS316L
 BACKGROUND : WHITE (RAL 9010)
 TEXT COLOUR : BLACK
 TEXT STYLE : ARIAL
 TEXT HEIGHT : 07 MM
 FIXING STYLE : SS SCREWED

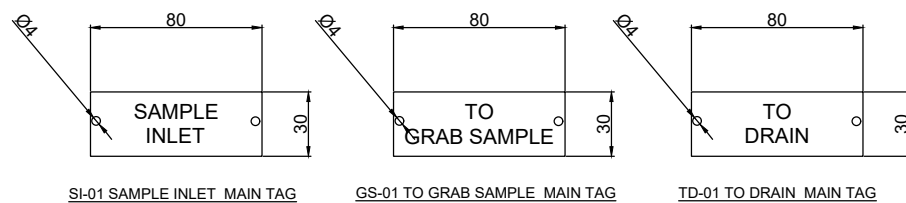

NOTES:
 DIMENSION : 80(W) x 30(H) x 1.5 (THK)
 MATERIAL : SS316L
 BACKGROUND : WHITE (RAL 9010)
 TEXT COLOUR : BLACK
 TEXT STYLE : ARIAL
 TEXT HEIGHT : 07 MM
 FIXING STYLE : SS SCREWED

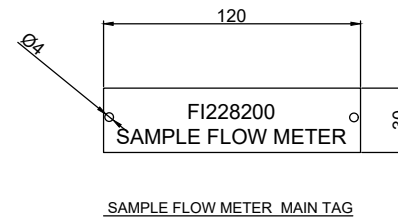

NOTES:
 DIMENSION : 120(W) x 30(H) x 1.5 (THK)
 MATERIAL : SS316L
 BACKGROUND : WHITE (RAL 9010)
 TEXT COLOUR : BLACK
 TEXT STYLE : ARIAL
 TEXT HEIGHT : 07 MM
 FIXING STYLE : SS SCREWED

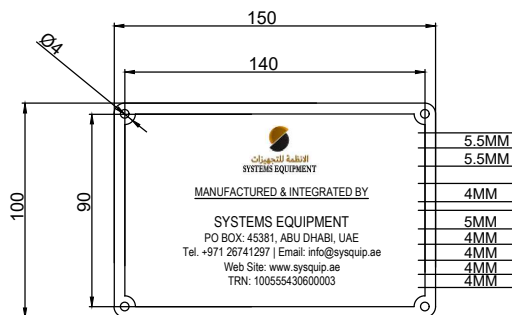

TAG PLATE DETAILS

MATERIAL: SS316
 SIZE: 150X 100MM
 THK: 1 MM
 CHARACTER COLOUR: BLACK
 TYPE: ENGRAVED
 QTY: 1 EA
 TEXT STYLE : ARIAL
 TEXT HEIGHT : MENTIONED

BV-02 2-WAY BALL VALVE MAIN TAG

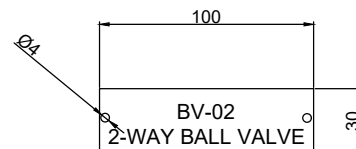

NOTES:
 DIMENSION : 100(W) x 30(H) x 1.5 (THK)
 MATERIAL : SS316L
 BACKGROUND : WHITE (RAL 9010)
 TEXT COLOUR : BLACK
 TEXT STYLE : ARIAL
 TEXT HEIGHT : 07 MM
 FIXING STYLE : SS SCREWED

REV	DATE	DESCRIPTION	DRAWN	CHKD	APPRD
C04	25-11-24	ISSUED FOR APPROVAL	VPS	WV	SP
C03	18-11-24	ISSUED FOR APPROVAL	RJK	WV	SP
C02	07-10-24	ISSUED FOR REVIEW	RJK	WV	SP
C01	12-09-24	ISSUED FOR REVIEW	RJK	WV	SP

SCALE: 1:1	DRAWN: RIJIN	CHKD: VMISH	APPRD: SINOGE
------------	--------------	-------------	---------------

CONTRACTOR
 ADVANCED PETRO SERVICES

VENDOR:
 SYSTEMS EQUIPMENT

PROJECT TITLE
 APS-252SYNERGY FOR PROCESS CONDENSATE, AMMONIA WATER AND UREA SOLUTION BETWEEN F-1 & F-2

DRAWING TITLE
 TOC & CONDUCTIVITY ANALYZER NAMEPLATE & TAGPLATE DRAWING

UNIT: mm	PLANT: XX-----XXX--X
CONTR. PROJ. No. SO-SE2024-0289	CONT. DWG. No.: SE24-0289-ED-ND-001
ADNOC AGREEMENT No. 102402-2024	
ADNOC PROJ. No. XXXX	ADNOC DWG. No. F2-00-CI-GEA-0005
SHEET 02/02	REV. C04

NOTICE: THIS DRAWING AND THE INFORMATION IT CONTAINS IS THE SOLE PROPERTY OF ADNOC GAS. IT SHALL NOT BE REPRODUCED OR LENT WITHOUT THE AGREEMENT OF THE OWNER.

CAD NO.: T_11

SHEET SIZE : A3